

DOUGLAS COLLEGE

CAMPUS GUIDE

**NEW WESTMINSTER CAMPUS
ANVIL OFFICE TOWER
2020 2021**

douglascollege.ca



DOUGLAS COLLEGE

N W P L P F P
C



ST-7

-32

-30

R
D
P2

-22

-21

ST-31

P
L
E
P3

P
L
E
P2

P
L
E
P1
EN
RANCE

LEVEL Ze / PARKING LEVEL

S F
N W C



LEVEL

N	G	S	Facility Lab, a e, L e a e
N	Lea. Re. ce a d L b a	S	a d Pe A
N	Lea. Ce e	S	S. de A a . & Se ce
N	Lec. e T. ea e		Acce b. Se ce & C.
N	Lec. e T. ea e	S	E Se ce
. A	Sec. K.	S	D. C. e l e a r
N	S. Soe ce H. a M. e e. Lab	S	Ea r. C. d Ed. ca. Ce e
N	S. Soe ce H. a e e. Lab #	S	F. Se de O ce
N	Fac. A. ca. (DCFA)		Wa e Fr. Sa.
N	Ca e e a		AED L ca.

LEVEL

N	Academic Technology Service	S	Language Lab
N	Faculty Language, Learning and Performance Area	S	Biotech Lab
N	Music Lab	S	Health Affairs & Prevention Lab
N	Studio B/Rehearsal	S	Chemistry Lab
N	Studio BC	S	Earth and Environmental Science
N	Dance Studio	S	Soece
N	Medical Lab	S	Earth and Environmental Science Soece Lab
N	Studio A/Band Room	S	Faculty Soece and Technology
N	Specialized Writing	S	Math Lab
N	Faculty Health and Safety Soece	S	Water Filtration
N	Geography Lab		AED Laboratory
N	Physics Lab		

F N W , F S C F



LEVELS , &

N	Area Director's Office	S	Administrative Services, Practice
N	Parade	S	Finance
N	Human Resources	S	Facilities Services ;
N	Legal Counsel / Personnel	S	Sales, Security & Risk
N	Account Executive		Marketing ; Procurement ;
N	Student Teacher	S	Information (FNMI) Services
N	Facilities Construction	S	Services
N	Business Administration	S	Security Administration
S	Student Services	S	Board
	Construction	S	Water / Sewer
			AED Location

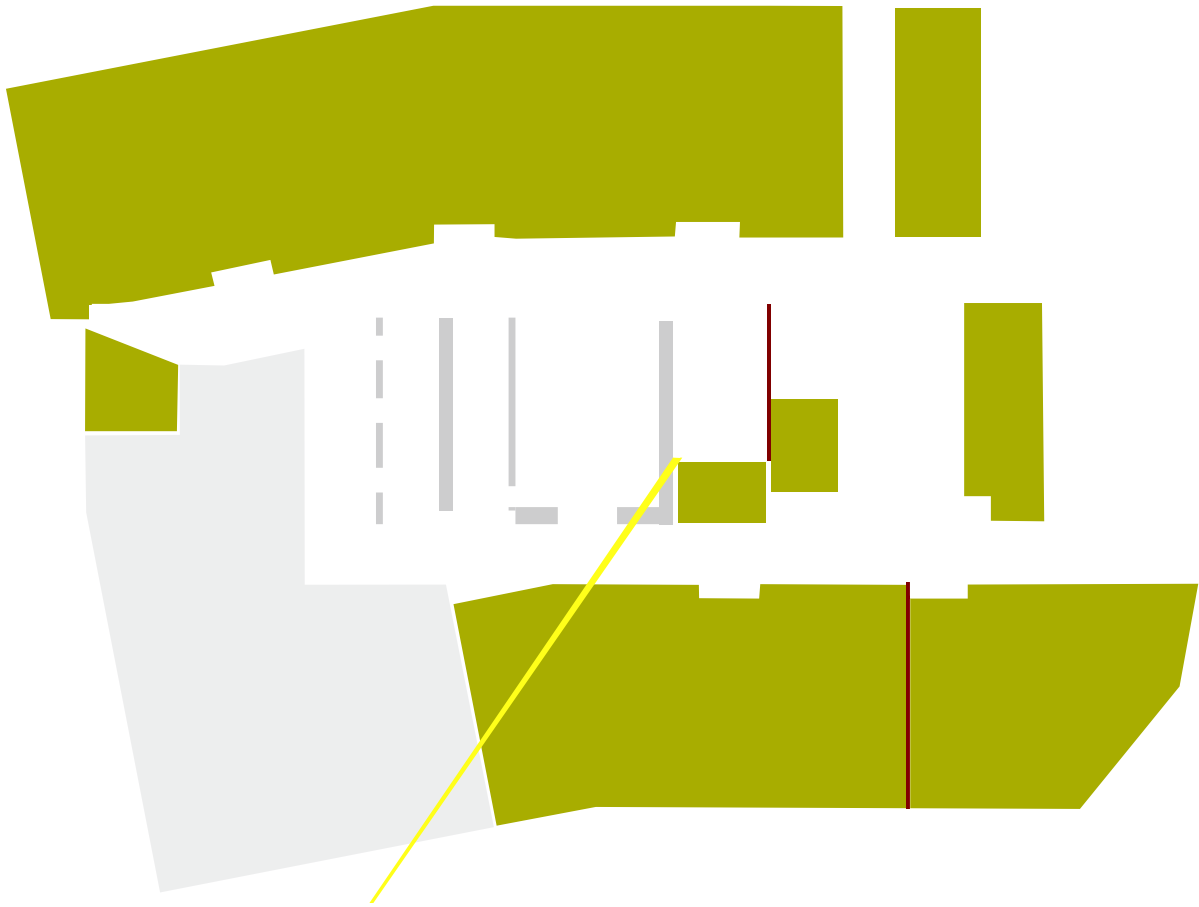

ANVIL FLOOR

ANVIL  FLOOR



CAMPUS STREET ADDRESSES

1000 Royal Avenue (at Eglinton Street), New West Campus, B.C.
 4000 Oxford Terrace (at Eglinton Street, Fraser Heights), New West Campus, B.C.

MAILING ADDRESS FOR ALL CAMPUSES

PO Box 180000, New West Campus, B.C., V1L 1B8

CENTRAL SWITCHBOARD

778-782-5000

CAMPUS HOURS

Monday - Friday 9:00 a.m. - 5:00 p.m.
 Saturday 9:00 a.m. - 5:00 p.m.
 Sunday 10:00 a.m. - 4:00 p.m. (limited access *)
 Holidays Limited access *

* Access to Library building. Vandal damage to
 Douglas College ID badge will be reported to the Office of
 Safety at the New West Campus.

ACCESS FOR VISITORS OR STUDENTS WITH DISABILITIES

Referred, a person with a physical disability may require a
 wheelchair, a guide dog, a hearing aid, a hearing aid, a
 New West Campus. Please call the Accessibility Services
 at a rabre@Astr.

INFORMATION

Library and bookstore. Security of the College (see direction)
 at the New West Campus and the Fraser Heights Campus.
 See the website at Astr.

ROOM NUMBERS

The New West Campus is divided into
 blocks, North and South. Each block is subdivided into
 buildings and wings. A complete list of
 buildings and wings is available on the New West Campus and
 Fraser Heights websites.

FOOD SERVICE

Meal and snack areas are available in the
 Fraser Heights and Douglas College (Fraser Heights)
 and Douglas College. Dining services are available in the
 Douglas College (Fraser Heights).

SMOKE FREE CAMPUS

Douglas College is a smoke-free campus. The
 Fraser Heights, Fraser Heights, and Douglas College
 and Douglas College are a smoke-free campus.
 See the website at Astr.

SECURITY

Fraser Heights, Fraser Heights, and Douglas College
 are smoke-free, smoke-free, and Douglas College. Security and
 Fraser Heights and Douglas College are a smoke-free campus.
 See the website at Astr.